



Translating Research into Practice & Policy



19TH ANNUAL UCLA
NURSING SCIENCE & INNOVATION CONFERENCE

Wednesday, May 31, 2023
Covel Commons



WELCOME TO THE 19TH ANNUAL UCLA NURSING SCIENCE & INNOVATION CONFERENCE

This one-day on-site conference is intended to provide an opportunity to raise awareness of new health care trends, while supporting quality improvement, evidence-based practice, research and innovation at the bedside.

The 2023 conference program features a wide range of topics that highlight the importance of translational research and the development of clinically relevant therapeutic strategies to reduce risk and advance care. We are pleased to welcome our morning & afternoon keynote speakers, Eileen M. Sullivan-Marx, PhD, RN, FAAN, Dean of the New York University Rory Meyers College of Nursing, and Linda L. Chlan, PhD, RN, ATSF, FAAN, Associate Dean for Nursing Research, Mayo Clinic.

The conference will also feature an impressive range of podium and poster presentations representing researchers, clinicians, educators, and students.

A few reminders:

- Please wear your name badge to all conference functions.
- All General and Plenary Sessions will be held in Grand Horizon Room.
- Breakout Sessions and Poster Presentations will be held in various locations. Please see the agenda for details.

CONFERENCE INFORMATION

Electronic Devices

Please silence cell phones, computers and electronic devices before entering an educational session. All phone conversations should be conducted outside the meeting rooms.

Complimentary WiFi

WiFi is available at Covell Commons - no password is required
Meeting Network: UCLA_WEB

Continuing Education (CE) Contact Hours

Nurses will be awarded 5.83 ANCC contact hours for participation in this event. UCLA Health is accredited as a provider of continuing nursing education by the American Nurses Credentialing Center's Commission on Accreditation. Provider approved by the California Board of Registered Nursing, Provider Number 12511 for 7 contact hours.

Instructions for claiming CNE Contact Hours:

To receive CE contact hours, attendees must:

- Be registered as a participant.
- Be seated in the room no later than 10 minutes after the session has started, and remain in the session until the scheduled ending time.
- To obtain ANCC and BRN contact hours, you must complete the online evaluation form in Cornerstone by no later than July 1, 2023.
- For technical assistance with the CE evaluation or certificate, please email researchebp@mednet.ucla.edu.
- Complete the required evaluation and print and/or save certificate.

Presentations

Poster session materials will be available online to registered attendees only through July 1, 2023. You will receive instructions on how to access the presentations in a post-conference email communication.

Social Media

We encourage conference attendees to interact on social media! Follow the conference on Facebook, Twitter, and Instagram using the conference hashtag #UCLANSI23 for the latest updates and to join the conversation. Also, include any of the following in your posts: @UCLAHealth, @UCLANursing.



ACKNOWLEDGEMENTS

UCLA Health Research & Innovation Council

Lianna Ansryan, MSN, CNS, PHN, GERO-BC,
AGCNS-BC, FCNS
Ashley Bender BSN, RN, CCRN—NIC
Mithun Mahinda, BSN, RN, CCRN-CMC
Kathleen Feldman, MBA, MSN, RN, NPJ-BC
Amy Goldberg, MSN, RN, CPNP, CPN, NE-BC
Mandy Jasdhaval, MSN, RN, ACNS-BC
Won Hee Kim, BSN, RN
Susan Mahnovski, MS, RN-BC, CNL
Dahlia Maldonado, BSN, RN-BC
Taline Marcarian, PhD, RN, CCRN-CSC
Valentina Obreja, DNP, RN, AG/ACNP-BC, CCRN-
CSC/CMC, PHN, EBP-C
Sangyoung Yu-Choi, MSN-Ed, RN, PCCN-K, NPJ-BC
Onike Williams, MSN, NP-C

UCLA School of Nursing Research Committee

Dong An, MD, PhD
Mary-Lynn Brecht, PhD
Catherine Carpenter, PhD
Holli DeVon, PhD, RN, FAAN, FAHA
Rosario Jaime-Lara, PhD, FNP, RN
Robert Lucero, PhD, MPH, RN, FAAN
Nancy Pike, PhD, RN, CPNP-AC/PC, FAHA, FAAN
Christine Samuel-Nakamura, PhD, RN, FNP-BC

Center for Nursing Excellence

Jaehee Choi, RDMS
Kathleen Feldman, MBA, MSN, RN, NPJ-BC
Lee Galuska, PhD, RN, NEA-BC
Karyn Greenstone, BS
Theresa Kirkpatrick, MSN, RN, CPNP,
CCRN, CNS
Mary Lawanson-Nichols, MSN, RN, CNS,
NP, CCRN
Fotina (Tina) Mamais, MSN, RN, BC-GCNS, GNP
Pamela Miller, PhD, RN, ACNP, CNS, PHN,
EBP-C
Kelli Obazee
Jessica Phillips, PhD, RN, NPJ-BC
Jennifer Pysz, MHSA, BS
Martha Schneider, DNP, RN, NEA-BC,
NPJ-BC
Lisa Steurer, PhD, RN, CPNP-PC
Kissy Vasquez



ACKNOWLEDGEMENTS

Leadership

Co-Chairs:

Holli DeVon, PhD, RN, FAAN, FAHA

Pamela Miller, PhD, RN, ACNP, CNS, PHN, EBP-C

David Bailey, PhD, RN, MBA, CCRN-K, NEA-BC, FACHE, FAAN

Quanna Batiste-Brown, DNP, HCSM, FABC, RN, NEA-BC

Lee Galuska, PhD, RN, NEA-BC

Karen Grimley, PhD, MBA, RN, FACHE, NEA-BC

Patrick Loney, MBA, RN

Donna M. Wellbaum, MSN, RN-BC

Lin Zhan, PhD, RN, FAAN

UCLA Health Talent Acquisition

Special Thanks:

Jaehee Choi, RDMS, Analyst | UCLA Health

Kathleen Feldman, MBA, MSN, RN, NPD-BC

Aaron Hilf, Director of Communications | UCLA School of Nursing



MORNING PLENARY

KEYNOTE SPEAKER

Eileen M. Sullivan-Marx, PhD, RN, FAAN

Immediate Past President, American Academy of Nursing
Dean & Erline Perkins McGriff Professor, New York
University Rory Meyers College of Nursing

Dr. Sullivan-Marx has served as the Dean of the Rory Meyers College of Nursing from 2012-2023 during which she led the school to its now independent status as a college, growing its national reputation as a leader in nursing research, establishing a new home for the college of nursing, raising \$50 million including a naming gift for the college.



As an expert in medical payment models, Medicare and Medicaid policy, her research demonstrated how innovative care models can be sustained. As an expert in aging issues she has had extensive experience in city, state and federal commissions and nonprofit boards. She led the prestigious American Academy of Nursing as president during the COVID-19 pandemic while also chairing NYU's Deans Council.

Dr. Sullivan-Marx had an active practice career in community and hospital nursing before becoming a primary care nurse practitioner in 1980 at the University of Rochester. As an NP she established numerous NP roles in aging care and opened her own primary care practice in a rural area in 1988. At Penn, she oversaw the growth and success of a Program for All Inclusive Care for Elders (PACE) in West Philadelphia. She received her diploma, BSN, and PhD from the University of Pennsylvania School of Nursing. Dr. Sullivan-Marx holds adjunct faculty positions at Howard University and the University of Pennsylvania.

AFTERNOON PLENARY

KEYNOTE SPEAKER



Linda L. Chlan, PhD, RN, ATSF, FAAN

Associate Dean for Nursing Research, Mayo Clinic

Dr. Linda Chlan is the Associate Dean for Nursing Research with responsibilities to lead Mayo Clinic nursing research across all campuses. In addition to her administrative role, Dr. Chlan maintains an active program of extramurally supported research focused on developing and testing symptom

management interventions for critically ill patients receiving mechanical ventilatory support funded by the National Heart, Lung and Blood Institute and the National Institute on Aging, National Institutes of Health. She is a Fellow in the American Academy of Nursing and a Fellow of the American Thoracic Society. She was inducted into the Sigma Theta Tau International Nursing Honor Society's international nursing research Hall of Fame in recognition for the impact of her science.

AGENDA

Time	Session Event	Location
8:00 a.m. – 9:00 a.m.	Registration and Breakfast	Rotunda and North Hallway
9:00 a.m. - 9:05 a.m.	Welcome Remarks K. David Bailey, PhD, RN, MBA, CCRN-K, NEA-BC, FACHE, FAAN <i>Chief Nursing Officer, UCLA Santa Monica Medical Center</i>	Grand Horizon Room
9:05 a.m. – 10:00 a.m.	Opening Keynote Address Introduction Lin Zhan, PhD, RN, FAAN <i>Dean, UCLA School of Nursing</i> Keynote Speaker Eileen M. Sullivan-Marx, PhD, RN, FAAN <i>Dean, New York University Rory Meyers College of Nursing</i>	Grand Horizon Room
10 a.m. – 10:10 a.m.	Transition Break	
10:10 a.m. – 11:10 a.m.	Podium Session I	West Coast, North Ridge, South Bay, & Grand Horizon
11:10 a.m. – 12:00 p.m.	Poster Session I	Grand Horizon Room, South Hallway, Rotunda, Lounge Area (adjacent to breakout rooms)

AGENDA

Time	Session Event	Location
12:00 p.m. – 1:00 p.m.	Lunch	North Hallway, Terrace, Grand Horizon Room
1:00 p.m. – 1:10 p.m.	Transition Break	
1:10 p.m. – 2:10 p.m.	Podium Session II	West Coast, North Ridge, South Bay, & Grand Horizon
2:10 p.m. – 3:00 p.m.	Poster Session II	Grand Horizon Room, South Hallway, Rotunda, Lounge Area (adjacent to breakout rooms)
3:00 p.m. – 3:15 p.m.	Refreshment Break	North Hallway
3:15 p.m. – 4:15 p.m.	<p>Closing Keynote Speaker</p> <p>Introduction Holli DeVon, PhD, RN, FAAN, FAHA <i>Assoc. Dean for Research, UCLA School of Nursing</i></p> <p>Keynote Speaker Linda L. Chlan, PhD, RN, ATSF, FAAN <i>Associate Dean for Nursing Research, Mayo Clinic</i></p>	Grand Horizon Room
4:15 p.m. – 4:30 p.m.	Poster Awards/Adjournment	Grand Horizon Room

Podium Abstracts

Morning Sessions

TIME	Abstract & Presenter	Room
10:10 - 10:30am	The Characteristics and Clinical Outcomes of Patients Acquiring Infections During Extracorporeal Membrane Oxygenation (ECMO) Run <i>Session Theme: Acute and Chronic Conditions</i> Weiting Chen, BSN, RN, CCRN, CSC Valentina Obreja, DNP, AG/AC NP-BC, CCRN, CSC, CMC, PHN, EBP-C <i>Ronald Reagan UCLA Medical Center</i>	North Ridge
10:30 - 10:50am	Prehospital Delay, Symptoms, and Healthcare Utilization for Acute Coronary Syndrome: Changing Policy to Advance Health Equity <i>Session Theme: Acute and Chronic Conditions</i> Holli A. DeVon, PhD, RN, FAAN, FAHA Sahereh Mirzaei, PhD, RN <i>UCLA School of Nursing</i>	North Ridge
10:50 - 11:10am	From Referral to the Evaluation: A Narrative Study on Factors Associated with Patients Lost to Follow-up in Kidney Transplant <i>Session Theme: Acute and Chronic Conditions</i> Jill Scherrey, MSN, RN <i>UCLA School of Nursing</i>	North Ridge
10:10 - 10:30am	Implementing a Nursing-Led Community Health Program for People Experiencing Homelessness <i>Session Theme: Improving Safety, Quality, Delivery, and Value Across the Continuum</i> Brian Zunner-Keating, MS, RN Kendal Wilkie, BS, RN <i>UCLA Health</i>	West Coast

Podium Abstracts

Morning Sessions

TIME	Abstract & Presenter	Room
10:30 - 10:50am	Preventing recurrent NASH (non-alcoholic steatohepatitis) post liver transplant - a QI project to address gaps in care <i>Session Theme: Improving Safety, Quality, Delivery, and Value Across the Continuum</i> Katherine Meneses, DNP, FNP-BC, CCTC Susan Kang, MSN, ANP-BC, CCTC Ronald Reagan UCLA Medical Center	West Coast
10:50 - 11:10am	Sustained Reduction in Central Line Infections Through Nurse-Driven Initiatives in an Acute Care Surgical Transplant Unit <i>Session Theme: Improving Safety, Quality, Delivery, and Value Across the Continuum</i> Kristen J. Chin, BSN, RN, CCTN Ronald Reagan UCLA Medical Center	West Coast
10:10 - 10:30am	Positive and negative selection of anti-HIV-1 gene-modified human hematopoietic stem/progenitor cells (HSPC) to improve engraftment and efficient HIV-1 inhibition with a safety kill switch in humanized BLT mice <i>Session Theme: HIV</i> Qi Guo, PhD Wannisa Khamaikawin, PhD UCLA School of Nursing UCLA AIDS Institute	South Bay
10:30 - 10:50am	Mental Health in Burmese Refugees during the Current Myanmar Civil War <i>Session Theme: HIV</i> David Tanoko Sarah Oung B.S. Student UCLA School of Nursing	South Bay

Podium Abstracts

Morning Sessions

TIME	Abstract & Presenter	Room
10:50 - 11:10am	<p>Investigating Betel Nut Use among People Living with HIV in Myanmar: The Role of HIV Stigma, Physiological Arousal, and Mental Health Factors</p> <p><i>Session Theme: HIV</i></p> <p>BoRam Kim, PhD, RN Wei-Ti Chen, PhD, RN, CNM, FAAN <i>UCLA School of Nursing</i></p>	South Bay
10:10 - 10:30am	<p>Don't Make a Mistake, Prepare for an Earthquake!</p> <p><i>Session Theme: Promoting Effective Collaboration, Leadership, Communication and Education: Implications for Patient Outcomes and Clinician Practice</i></p> <p>Ivanne Monsod, BSN, RN, CNII Earl Mikhail Uychocde, BSN, RN, CNOR <i>UCLA Santa Monica Medical Center</i></p>	Grand Horizon
10:30 - 10:50am	<p>Reducing Overcrowding during an Emergency to Improve Team Communication and Role Identification: A Quality Improvement Crowd Control Initiative</p> <p><i>Session Theme: Promoting Effective Collaboration, Leadership, Communication and Education: Implications for Patient Outcomes and Clinician Practice</i></p> <p>Alexis Fitten, BSN, RN, CCRN Chia-Yen (Cathy) Li, EdD, MSN, RN, PHCNS-BC, CHSE, NPD-BC <i>Ronald Reagan UCLA Medical Center/UCLA Health</i></p>	Grand Horizon

Podium Abstracts

Afternoon Sessions

TIME	Abstract & Presenter	Room
10:50 - 11:10am	<p>Successful Inter-Professional Team (IPT) Collaboration in the Care of Peripartum Women with COVID-19 on Extracorporeal Membrane Oxygenation (ECMO)</p> <p><i>Session Theme: Promoting Effective Collaboration, Leadership, Communication and Education: Implications for Patient Outcomes and Clinician Practice</i></p> <p>Weiting Chen, BSN, RN, CCRN, CSC Valentina Obreja, DNP, AG/AC NP-BC, CCRN, CSC, CMC, PHN, EBP-C <i>Ronald Reagan UCLA Medical Center</i></p>	Grand Horizon
1:10 - 1:30pm	<p>Nurse-led implementation of a Medical Chaperone Program across a large academic medical system</p> <p><i>Session Theme: Improving Safety, Quality, Delivery, and Value Across the Continuum</i></p> <p>Quanna Batiste-Brown, DNP, RN Katie Siedel, MPH, MSW <i>UCLA Health</i></p>	Grand Horizon
1:30 - 1:50pm	<p>The Department of Medicine (DOM) Peer Review Program</p> <p><i>Session Theme: Improving Safety, Quality, Delivery, and Value Across the Continuum</i></p> <p>Frances T. Schiff, BSN, RN, CPHQ Anna Dermenchyan, PhD, RN, CCRN-K, CPHQ <i>Department of Medicine, DGSOM</i></p>	Grand Horizon
1:50 - 2:10pm	<p>Title: Discharge Patients When They Are Ready, No Need to Wait for Approval.</p> <p><i>Session Theme: Improving Safety, Quality, Delivery, and Value Across the Continuum</i></p> <p>Melissa Reider-Demer, DNP, MN, CNP <i>UCLA Health System</i></p>	Grand Horizon

Podium Abstracts

Afternoon Sessions

TIME	Abstract & Presenter	Room
1:10 - 1:30pm	Decreasing Intraoperative Skin Damage in Prone Position Surgeries <i>Session Theme: Pressure Injury/Patient Positioning</i> Barbara Bates-Jensen, PhD, RN, FAAN Heather McCreath, PhD <i>UCLA School of Nursing</i>	West Coast
1:30 - 1:50pm	Process and Outcomes of Prone Position Therapy (PPT) for Extracorporeal Membrane Oxygenation (ECMO) Patients with COVID-19 <i>Session Theme: Pressure Injury/Patient Positioning</i> Weiting Chen, BSN, RN, CCRN, CSC Valentina Obreja, DNP, AG/AC NP-BC, CCRN, CSC, CMC, PHN, EBP-C <i>Ronald Reagan UCLA Medical Center</i>	West Coast
1:50 - 2:10pm	Silicone Contact Layer (SCL) Preventative Dressing to Decrease Medical Device-Related Pressure Injuries on the Ears From Oxygen Devices (MDRPI-OE-OD) <i>Session Theme: Pressure Injury/Patient Positioning</i> Geronimo Fulgentes, MSN, RN, CWOCN, PCCN Veronica Mercado, BSN, RN, CWON <i>UCLA Santa Monica Medical Center</i>	West Coast
1:10 - 1:30pm	Work Environment and Wellbeing Among Prison Nurses in California: An Investigation During the COVID-19 Pandemic <i>Session Theme: Promoting Effective Collaboration, Leadership, Communication and Education: Implications for Patient Outcomes and Clinician Practice</i> Megan Guardiano, BS, RN, PHN Paul Boy, MSN, APRN-BC, RN, PCCN, PHN <i>UCLA School of Nursing</i>	North Ridge

Podium Abstracts

Afternoon Sessions

TIME	Abstract & Presenter	Room
1:30 - 1:50pm	<p>Impact of a Virtual Reality Simulation Modality Compared to Traditional Education on Nurse Knowledge, Nurse Behavior, and C'Difficile Rates: A Randomized Control Trial</p> <p><i>Session Theme: Promoting Effective Collaboration, Leadership, Communication and Education: Implications for Patient Outcomes and Clinician Practice</i></p> <p>Jessica M. Phillips, MSN, RN, NPD-BC, PhD Chia-Yen (Cathy) Li, EdD, MSN, RN, PHCNS-BC, CHSE, NPD-BC UCLA Health System</p>	North Ridge
1:50 - 2:10pm	<p>Nursing Research Leadership during Covid-19 at a Community Hospital</p> <p><i>Session Theme: Promoting Effective Collaboration, Leadership, Communication and Education: Implications for Patient Outcomes and Clinician Practice</i></p> <p>Lisa Diaz, RN, MSN, CDCES UCLA School of Nursing/PVHMC</p>	North Ridge
1:10 - 1:30pm	<p>Compromised Cerebral Artery Integrity is Associated with Brain Tissue Injury and Cognition Deficits in Adolescents with Complex Congenital Heart Disease</p> <p><i>Session Theme: Brain Research</i></p> <p>Nancy Pike, PhD, CPNP-AC/PC Bhaswati Roy, PhD UCLA School of Nursing/UCLA School of Medicine</p>	South Bay
1:30 - 1:50pm	<p>Cerebral functional near-infrared spectroscopy (fNIRS) monitoring during valsalva maneuver in obstructive sleep apnea</p> <p><i>Session Theme: Brain Research</i></p> <p>Lauren Furtick, MSN, RN UCLA School of Nursing</p>	South Bay

Poster Abstracts

Morning Session | 11:10 a.m. – 12:00 p.m.

Poster Number	Presenter(s) Poster Title
1	Janar Bauirjan, MSN, RN-BC, CNRN; Mithun Mahinda, BSN, RN, CCRN-CMC New Knowledge and Innovation Collaborative Model: 3 Facility NKIs Partnering with Nursing Informatics and Information Services & Solutions Teams
2	Sarah Delgado, DNP(c) MSN RN ACNP; Nancy Blake, PhD, RN, CCRN-K, NHDP-BC, NEA-BC, FACHE, FAONL, FAAN A Delphi Analysis of Staffing Policy: Unit-level Nurse-to-Patient Ratios
3	Carina Menjivar, DNP(c), MBA, MSN, RN, NEA-BC, CPHQ, CNML, LSSGB; Nancy Blake, PhD, RN. How Does a New Nurse Manager Development Program Impact Self-Assessed Competency for Nurse Managers with Less Than Seven Years of Experience in a Managerial Role?
4	Bianca Nguyen, BS; Manuel Venegas, BS. Exploring Physician-Nurse Relations Through the Lens of Intersectionality.
5	Taline Marcarian, PhD, RN, CCRN-CSC; Katrine Murray, MSN, RN, CCRN, NE-BC. Writing Group: An Empowering Path for Clinical Nurses.
6	Abigale Schucker, BSN, RN, CCRN, DNP student; Robin Pueschel, DNP, AGACNP-BC, RN, RNFA. The Impact of Nursing Staff Education on the awareness Post-Intensive Care Syndrome and The Loma Linda Critical Care Recovery Clinic: An Evidence-Based Practice Project.

Poster Abstracts

Morning Session | 11:10 a.m. – 12:00 p.m.

Poster Number	Presenter(s) Poster Title
7	Bernice Tan, DNP(c), FNP-C; Wendie Robbins, PhD, RN, FAAN, FAAOHN A Quality Improvement Project: Does Patient Education Impact Quality of Life?
8	Felicia Butnareanu, RN Intraoperative prolonged hypotension in geriatrics patients
9	Sarah Finifrock, BSN, RN; Sharon Zhang, BSN, RN Jamming Out the Jitters: Integration of Music Intervention on Surgical Units
10	Maki Jerden, DNP(c), MSN, GNP-BC, CWON, RNFA; Wendie Robbins, PhD, RN, FAAN, FAAOHN A Quality Improvement Pilot Project: Does Preoperative Ostomy Care Impact Patient Outcomes?
11	Holli A. DeVon, PhD, RN, FAAN, FAHA; Judith Schlaeger, PhD, CNM, LA(c), FAAN East Meets West: Acupuncture as a Complementary Therapy Reduces Pain in Stable Angina
12	Nicole E. Lewis, BSN, RN; Yeonsu Song, PhD, RN, FNP-C The Challenges and Rewards of Caregiving Among Caregivers of Persons with Cognitive Impairment
13	Karen A. Nelson, MSN, RN Factors Impacting End-Of-Life Decision-Making Among Community-Based, Chronically Ill Adults: An Integrative Review

Poster Abstracts

Morning Session | 11:10 a.m. – 12:00 p.m.

Poster Number	Presenter(s) Poster Title
14	Chloe Bridgeman, MSN, RN, CCRN; Melanie Donovan, BSN, RN Mobility Champions for Transplant/Surgical Patients in an Intensive Care Unit
15	Dahlia Maldonado, BSN, RN-BC; Yuki Arai, BSN, RN Nurse Led Post-Op Delirium Identification, Prevention, and Management
16	Rey Paolo Ernesto J. Roca III, MSN, RN, CNE, PMH-BC, PHN; Paul R. Boy, MSN, MPH, AGACNP-BC, AGPNP-C, PCCN, RN, PHN Cultural Connectivity and American Indian Suicide Ideation
17	Amanda Adolfo, BS(c); Mary Rezk-Hanna, PhD Association of Hookah (Water-pipe) Tobacco Smoking and Cardiovascular Disease-Related Exposure Biomarkers Among U.S. Users: The Population Assessment of Tobacco and Health Study
18	Shenita Anderson, MSN, RN, PhD(c) Unconventional Perceptions about Tobacco Use Among African American Light Smokers and Indications of Multi-Disciplinary approaches to Cessation Through Healthcare and Policy
19	Sonia Betancourt, DNP(c), MSN, APRN, FNP-C; Catherine Carpenter, PhD, MPH Dodge Diabetes: Prediabetes Awareness and Improved Attendance at Diabetes Prevention Programs
20	Theresa Kirkpatrick, MSN, RN, CNS; Amelia Tomlin, BSN, RN A Novel Pediatric CAUTI Risk Stratification Tool

Poster Abstracts

Morning Session | 11:10 a.m. – 12:00 p.m.

Poster Number	Presenter(s) Poster Title
21	Tracy Genuino, BSN, RN, CCRN; Anahit Sarin-Gulian, MSN, NE-BC; Won Hee Kim, BSN, RN; Stacy Meyer, MSN, RN, PCCN Journey to Zero Clabsi in Level IV NICU: Impact of Introducing a CHG Protocol Alongside Evidence-Based Interventions
22	Natalie Foo, MSN, RN-BC, PHN, PMHNP-BC; Abraham Urias, BSN, RN The Perceptions and Experiences of Frontline Nurses During the COVID-19 Pandemic
23	Sarah Oung, BSN student; David Tanoko, BSN student Access to Healthcare in Myanmar Refugees in Thailand During COVID Pandemic
24	Ashley S. Chu; Brandon T. Ton, BS Developing an analysis protocol for HRV changes to taking a sigh
25	Norman Cyprian, DHA, RN Implementing "The SHH - H-H-H Project," As a mean to decrease the noise level and enhance the patient satisfaction.
26	Tayley Dunivant, BSN, RN, CCRN; Rosalie V. Garcia, BSN, RN, CCRN Bundle it! Implementing best practices for zero hypothermic neonates
27	Wendi Gilchrist, DNP, WHCNP-C, PHN Implementation of an Evidence-Based Practice Postpartum Depression Educational Program for Registered Nurses

Poster Abstracts

Morning Session | 11:10 a.m. – 12:00 p.m.

Poster Number	Presenter(s) Poster Title
28	Primadya Sakti, BS; Mary Rezk-Hanna, PhD Flavored Electronic Nicotine Delivery System (ENDS) Use Among Youths in the United States: Insights from the Population Assessment of Tobacco and Health Study
29	Simona Campa, DNP(c), ACNP Remote Weight Management for Women with Obesity and Cardiovascular Disease
30	Stephanie Anne Romero, BS; Kristen R. Choi, PhD, RN, FAAN Improving Trauma-Informed Care for Youth in Inpatient Psychiatry: A Cross-Sectional Assessment of Screening Practices and Cross-System Collaboration

Afternoon Session | 2:10 p.m. – 3:00 p.m.

Poster Number	Presenter(s) Poster Title
31	Megan Guardiano, BS, RN, PHN; Timothy A. Matthews, BA, MS Preliminary Findings on Effort/Reward in the Workplace and Cognitive Function Among Workers in the United States
32	Christine Simbulan-Dizon, DNP(c), RN, FNP; Nancy Blake, PhD, RN, NEA-BC, FAAN Digital Approach to Resource-Sharing and Team Building: A Healthy Work Environment Initiative for Per Diem Nurse Practitioners in the Primary Care Setting

Poster Abstracts

Afternoon Session | 2:10 p.m. – 3:00 p.m.

Poster Number	Presenter(s) Poster Title
33	Lauren Smith, MSN, RN, MBA, CCRN; Rhonda Mildon, BSN, RN Improving Employee Engagement in a Medical Surgical/ Telemetry Unit
34	Joyce Wu, MSN student; Kristen R. Choi, PhD, RN, FAAN Nurse experiences of responding to the 2017 Las Vegas mass shooting: Qualitative exploration of patient care and clinician mental health during a mass casualty event
35	Sylvia Lambrechts, MPH, MA, CPHQ; Jennifer Zanotti-Davis, MS, RN, CNS Implementation of A1C Point of Care Testing (POCT) in primary care with clinical staff
36	Korie Bigbee, MSN, RN; Eden Bauer, PhD, RN Road Trip: The Journey of Survivorship after Allogeneic Stem Cell Transplant
37	Devie Charbonneau, BSN, RN; Liza Hoffman, MSN, RN Patient Self-Administered Nitrous Oxide in Urology Ambulatory Clinics: They Start the Work, We Do the Rest!
38	Priscila Gonzalez Quintero, RN, BSN, CMSRN Improving Nurses™ Knowledge and Practice of Ostomy Care to Prevent Complications and Reduce Readmissions
39	Vera Lopez, MSN, RN, PCCN; Sangyoung Yu-Choi, MSN, RN, PCCN-K, NPD-BC The adoption of artificial intelligence into physiologic alarm practices and its benefits

Poster Abstracts

Afternoon Session | 2:10 p.m. – 3:00 p.m.

Poster Number	Presenter(s) Poster Title
40	Monica Pavon, MSN, RN, CCRN; Valerie Yeo, MSN, GNP-BC, NE-BC Does An Increase In Inpatient Palliative Care Consults Reduce Readmissions in Geriatric Patients?
41	Mary Rezk-Hanna, PhD, RN, NP, FAAN, FAHA; Matthew J. Rossman, PhD Electronic Hookah (Waterpipe) Vaping Reduces Vascular Endothelial Function: The Role of Nicotine
42	C. Samuel-Nakamura, PhD Metal(loid)s in eight species of medicinal plants in an American Indian community impacted by Uranium mining
43	Kate Echereodo, BSN, RN, PHN, CNS(c) Improving Dementia Screening in the Intensive Care Unit (ICU) to Decrease Complications
44	Jan Xavienne Nunez, BSN, RN; Yoanna Villalta, MSN, RN Adult CAUTI Risk Stratification Tool
45	Katherine Story, BSN, RN, CCRN; Rebekah Chung, BSN, RN, CCRN The Implementation of Skin Care Champions for Pressure Injury Reduction in a Liver Transplant Surgical Intensive Care Unit
46	Bianca Ghermezian, MSN, RN, CCRN A Multifaceted Approach to Fall Prevention on a Neuroscience Unit
47	Yuriko Matsuo, MSN, APRN, PMHNP-BC Association between Healthy Lifestyle and Cognition in Adults with Down Syndrome: An Integrative Review

Poster Abstracts

Afternoon Session | 2:10 p.m. – 3:00 p.m.

Poster Number	Presenter(s) Poster Title
48	Paul M. Macey, PhD; Fernando Martinez, MS Anxiety reduction through engaging interoceptive and breathing rhythm networks: a pilot study of breathing meditation and controlled breathing
49	Bantale Ayisire, PhD(c), MSN, RN, PHN Stigmatization of Mental Illness among US based African Immigrant Nurses and its association with Occupational Burnout
50	Amy Speirs, NNP-BC; Brittany Davis, MD, NCMP Evaluation of the Most Common Selective Serotonin Reuptake Inhibitors Used in a Major Teaching Institution and Their Contribution to Neonatal Respiratory Distress
51	Grace Sund, MSN, RN, CPNP, CPHON, CNS; Theresa Kirkpatrick, MSN, RN, CPNP, CCRN, CNS Addressing Behavioral Health in the Pediatric Inpatient Environment - Do You Know What To Do?
52	Cherisse Watts, PhD(c), RN, PHN; Lauren Clark, PhD, RN, FAAN Exploring the Experiences of African American Parents in Navigating Diagnostic Developmental Screenings and Early Intervention Services for Their Children with Intellectual and Developmental Disability: A Scoping Review
53	Kristi K. Westphaln, PhD, RN, CPNP-PC Family-centered healing after childhood sexual abuse: Opportunities for Children’s Advocacy Centers

Poster Abstracts

Afternoon Session | 2:10 p.m. – 3:00 p.m.

Poster Number	Presenter(s) Poster Title
54	Victoria Abatay-Metoyer, MSN-Ed, PhD(c), RN Experiences of Parents Whose Child Resides in a Subacute Skilled-Nursing Facility
55	Victoria Aberbook, RNC-OB, C-EFM, CNS, MN Implementing a VTE Risk Scoring System for Patients admitted to Antepartum, Labor and Delivery, and Postpartum
56	Kathleen Anulao, DNP(c), FNP-BC, RN; Nancy Pike, Ph.D, RN, CPNP-AC/PC, FAHA, FAAN Impact of Preoperative Education Video in Pediatric Ophthalmology on Parent Satisfaction
57	Adaeze Anyanwu, MSN, RN, PHN; Benissa E. Salem, PhD, RN, MSN, PHN, CNL Impact of Social Media Use On the Physical and Mental Healthcare Decision-Making of African-American Women During the Postpartum Period: An Integrative Review
58	Terri Cole DNP(c), RN, NE-BC; Nancy Blake, PhD, RN, CCRN, NEA-BC, FAAN Briefing, TeamSteps, and Simulation for Safer Cesarean Deliveries

MAP AND DIRECTIONS TO UCLA COVEL COMMONS

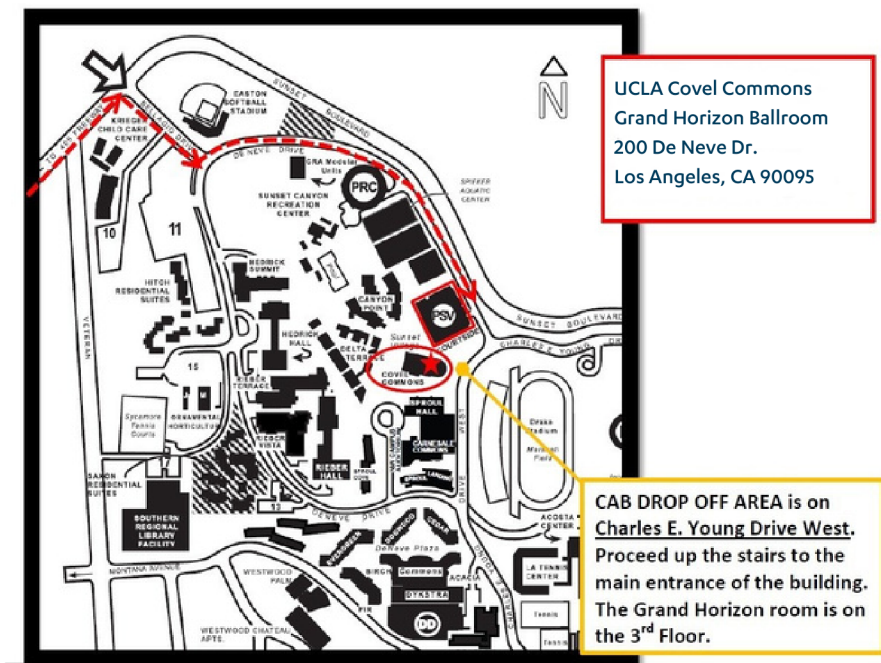

DRIVING DIRECTIONS (from the 405 FWY)

1. EXIT on Sunset Blvd. and head EAST.
2. RIGHT on Bellagio Dr.
3. LEFT onto De Neve Dr. After 3/10 of a mile, look for the PSV or SV (Sunset Village) parking structure on the right (before 2nd stop sign). Parking structure address is 330 De Neve Dr.
4. PARK and pay for permit at kiosk in PSV parking structure. Up to \$12 for all-day parking. Place permit on your dashboard. (NOTE: Do not park in Blue Permit areas.)
5. TAKE the elevators/stairs to the Lobby Level (L1).
6. WALK towards the right to the building's main entrance. The Grand Horizon Ballroom is on the 3rd floor.

COVEL COMMONS MAP

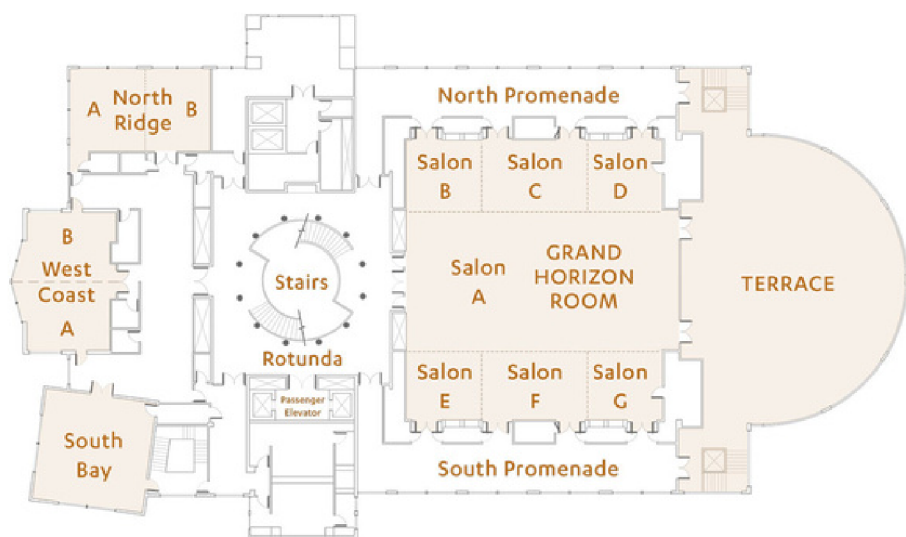

CENTER FOR NURSING EXCELLENCE

the **CENTER is the
one stop shop for**

- Certification
- Continuing Education
- Magnet
- Nursing Website
- Online Learning Modules
- Research, Evidence-Based Practice & Innovation
- Nursing Simulation
- Unit Practice, Relationship-Based Care, & Professional Governance
- Recognition & Acknowledgement
- Student Placement
- Nurse Residency
- Patient Education
- Competency and Required Education
- Advanced Practice

The Center For Nursing Excellence:
www.uclahealth.org/nursing

UCLA Health
Center for Nursing Excellence



UCLA School of Nursing

IS HIRING

**ADJUNCT FACULTY & LECTURER
ROLES AVAILABLE**



Join a Top 20 Nursing School

Undergraduate & Master's Programs

(U.S. News & World Report)

#24 in NIH Research Funding

16 Academy Fellows

70+ Years of Transformative Impact

LEARN MORE

nursing.ucla.edu/careers

DELIVER TRUE NURSING EXCELLENCE



At UCLA Health, we're one of the top hospitals in California - and the entire nation. And our extraordinary nursing professionals make all the difference. Their compassion and commitment to nursing excellence define our outstanding care while enabling us to achieve multiple Magnet® designations throughout our hospital system.

If you're looking to continually elevate your nursing career as you contribute to exceptional patient experiences, we invite you to join us and expand your career possibilities in our collaborative, empowering, state-of-the-art environment.

Apply today
by searching nursing
roles at



You can also connect
with us at one of
our upcoming events at





"70 Years Educating Nurses" Painting by Gregg Chadwick
in honor of our 70th Anniversary

Together, the UCLA School of Nursing and UCLA Health are helping shape nursing practice to improve the health of populations and communities.

UCLA School of Nursing

EVENT PARTNERS



Gamma Tau
at-Large Chapter

UCLA

Health

UCLA

**School of
Nursing**